

QUICK START GUIDE

G30 Smart Lock



EN

DE

FR

IT

ES

NL

PT

PL

I. Product Overview

G30 Smart Lock

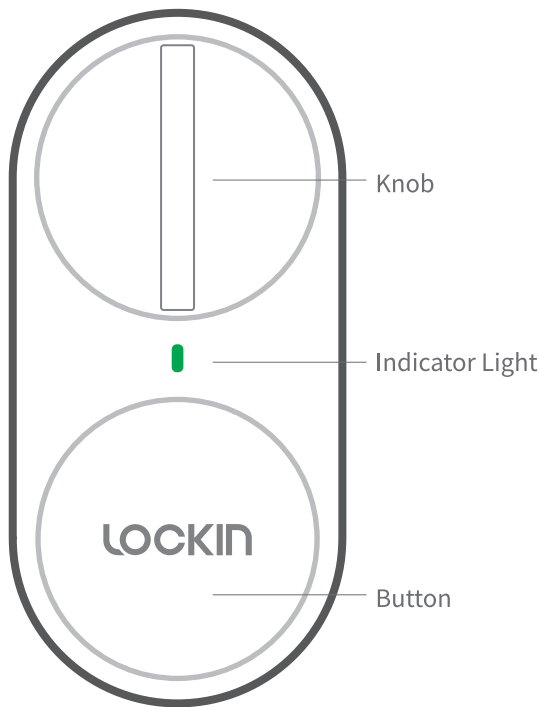

Product Specifications	
Model	G30 Smart Lock
Power Supply	4*AA Alkaline Batteries
Working Environment	0 -50°C, 90%RH, no condensation

II. Pairing Guide

1. Download the Lockin Home App and sign in or create an account.

A) Scan the QR Code below to download



*The Apple logo and App Store are trademarks of Apple Inc., registered in the U.S. and other countries and regions.

*Google Assistant, Google Home, Google Play, and the Google Play logo are trademarks of Google LLC.

B) Search for the Lockin Home in Apple App Store or Google Play

2. Follow the instructions below to pair your mobile device and Lockin Smart Lock.

2.1. Remove the battery cover, install four alkaline dry batteries, remove the insulation strip, and then close the battery cover.

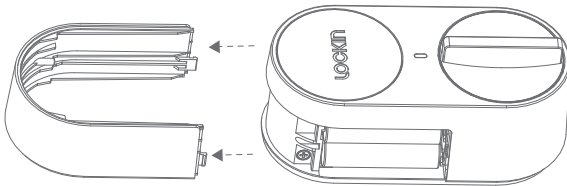

*1. Use 1.5V AA alkaline batteries only. Do not mix new and old batteries.

*2. Do not use rechargeable batteries.

2.2. Long press the button of G30 Smart Lock for about 3 seconds until you hear a "beep" sound, and you will see the green light blinks, which indicates that the device is in the pairing mode.

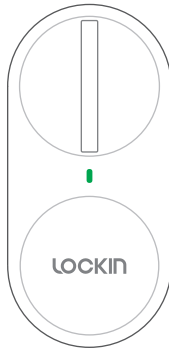

2.3. Open the Lockin Home App and follow the steps below to complete the pairing.

- a) Tap the "+" button in the upper right corner
- b) Tap Add Manually
- c) Tap G30 Smart Lock
- d) Follow the prompts on the app to complete the pairing

*Make sure that your mobile phone's Bluetooth is enabled, and the Lockin Home App is allowed to access your mobile phone's Bluetooth services.

2.4. Follow the prompts on the app to calibrate. If you have skipped the calibration or there are calibration errors, you may follow the steps below to complete the recalibration.

- a) Tap G30 Smart Lock on the app homepage to enter the G30 Smart Lock page
- b) Tap Settings
- c) Tap Initial Setup Guide

III. Function Description

Function	How to Set	Descriptions
Bluetooth Unlock	1. Open the Lockin Home app 2. Tap G30 Smart Lock 3. Slide the key button at the bottom of the screen to the right	1. When the Gateway is online, the lock can be controlled remotely. 2. When your mobile phone is connected to the lock via Bluetooth, the lock can be controlled at close range.
Auto Lock (With Door Sensor)	(A door sensor has been installed before calibrating the lock) 1. Open the Lockin Home app 2. Tap G30 Smart Lock 3. Tap Settings 4. Enable Auto Lock 5. Set any "Auto Lock Time"	Door sensor refers to a sensor that allows the lock to detect the magnetic field strength for auto lock after the door is closed. When the lock is calibrated after the door sensor has been correctly installed, the lock enters the With Door Sensor Mode. If there is a door sensor, G30 Smart Lock will automatically close if the specified "Auto Lock Time" has elapsed after G30 Smart Lock detects the magnetic field (after the door is closed). An alarm will be triggered if the door is not closed and not locked after the "Door Open Alarm Time" has elapsed.
Auto Lock (Without Door Sensor)	(No door sensor has been installed before calibrating the lock) 1. Open the Lockin Home app 2. Tap G30 Smart Lock 3. Tap Settings 4. Enable Auto Lock 5. Set any "Auto Lock Time"	 If there is no door sensor, G30 Smart Lock will automatically close when the specified "Auto Lock Time" has elapsed after it opens. An alarm will be triggered if the door is not locked when the "Door Open Alarm Time" has elapsed.
Temporarily Disable Auto Lock	After enabling Auto Lock, press G30 Smart Lock button three times.	Restore to Auto Lock: press G30 Smart Lock button three times, or lock once.

IV. Light Indication

1. G30 Smart Lock

Solid green: unlocked/locked successfully

Blinking green: pairing mode

Solid red: unlock failure/lock failure

Blinking red: low battery warning/locked jam warning

Federal Communication Commission Interference Statement

This device complies with Part 15 of the FCC Rules. Operation is subject to the following two conditions:

(1) This device may not cause harmful interference, and (2) this device must accept any interference received, including interference that may cause undesired operation.

This equipment has been tested and found to comply with the limits for a Class B digital device, pursuant to Part 15 of the FCC Rules. These limits are designed to provide reasonable protection against harmful interference in a residential installation. This equipment generates, uses and can radiate radio frequency energy and, if not installed and used in accordance with the instructions, may cause harmful interference to radio communications. However, there is no guarantee that interference will not occur in a particular installation. If this equipment does cause harmful interference to radio or television reception, which can be determined by turning the equipment off and on, the user is encouraged to try to correct the interference by one of the following measures:

- Reorient or relocate the receiving antenna.
- Increase the separation between the equipment and receiver.
- Connect the equipment into an outlet on a circuit different from that to which the receiver is connected.
- Consult the dealer or an experienced radio/TV technician for help.

FCC Caution:

Any changes or modifications not expressly approved by the party responsible for compliance could void the user's authority to operate this equipment.

FOR MOBILE DEVICE USAGE (>20cm/low power)

Radiation Exposure Statement:

This equipment complies with FCC radiation exposure limits set forth for an uncontrolled environment. This equipment should be installed and operated with minimum distance 20cm between the radiator & your body.

Industry Canada statement

This device contains licence-exempt transmitter(s)/receiver(s) that comply with Innovation, Science and Economic Development Canada's licence-exempt RSS(s). Operation is subject to the following two conditions:

- 1) This device may not cause interference.
- 2) This device must accept any interference, including interference that may cause undesired operation of the device.

L'émetteur/récepteur exempt de licence contenu dans le présent appareil est conforme aux CNR d'Innovation, Sciences et Développement économique Canada applicables aux appareils radio exempts de licence. L'exploitation est autorisée aux deux conditions suivantes :

- 1) L'appareil ne doit pas produire de brouillage;
- 2) L'appareil doit accepter tout brouillage radioélectrique subi, même si le brouillage est susceptible d'en compromettre le fonctionnement.

FOR MOBILE DEVICE USAGE (>20cm/low power)

Radiation Exposure Statement:

This equipment complies with IC RSS-102 radiation exposure limits set forth for an uncontrolled environment. This equipment should be installed and operated with minimum distance 20cm between the radiator and your body.

Déclaration d'exposition aux radiations:

Cet équipement est conforme aux limites d'exposition aux radiations IC CNR-102 établies pour un environnement non contrôlé. Cet équipement doit être installé et utilisé avec une distance minimale de 20cm entre le radiateur et votre corps.

CAUTION

Risk of explosion if the battery is replaced an incorrect disposal of a battery into fire or a hot oven, or mechanically crushing or cutting of a battery, that can result in an explosion; leaving a battery in an extremely high temperature surrounding environment that can result in an explosion or the leakage of flammable liquid or gas; battery subjected to extremely low air pressure that may result in an explosion or the leakage of flammable liquid or gas.

EU Declaration of Conformity

Hereby, [Name of manufacturer] declares that the radio equipment type [designation of type of radio equipment] is in compliance with Directive 2014/53/EU. The full text of the EU declaration of conformity is available at the following internet address:<http://www.lockin.com>

Operation Frequency:

Lockin Smart Lock	Y1	2402MHz to 2480MHz
-------------------	----	--------------------

Maximum Output Power:

Lockin Smart Lock	Y1	4dBm
-------------------	----	------

Under normal use of condition, this equipment should be kept a separation distance of at least 20 cm between the antenna and the body of the user.

WEEE Information



All products bearing this symbol are waste electrical and electronic equipment (WEEE as in directive 2012/19/EU) which should not be mixed with unsorted household waste.

Instead, you should protect human health and the environment by handing over your waste equipment to a designated collection point for the recycling of waste electrical and electronic equipment, appointed by the government or local authorities. Correct disposal and recycling will help prevent potential negative consequences to the environment and human health. Please contact the installer or local authorities for more information about the location as well as terms and conditions of such collection points.

G30 Smart Lock

Installation Instructions
European Standard

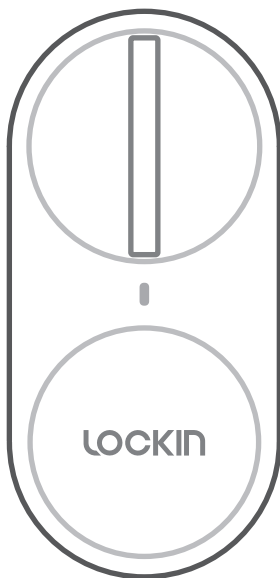

EN

DE

FR

IT

ES

NL

PT

PL

Accessory



Door Sensor

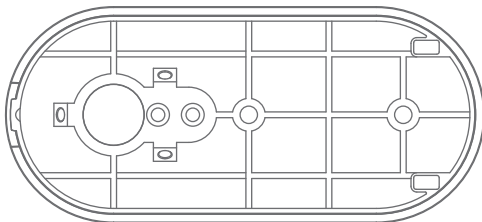

Baseboard



Screwdriver ①



Screwdriver ②



Screw M3*6



Fastening screw

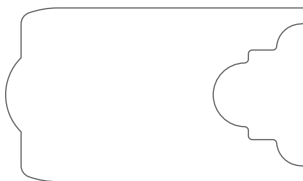

Double-sided tape

1. Install the bottom plate

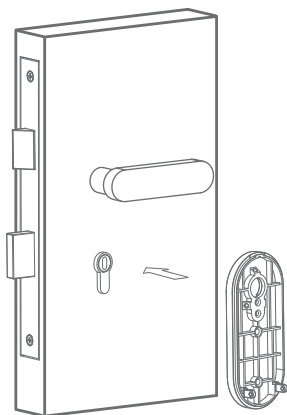

2. Ensure the bottom plate is installed properly

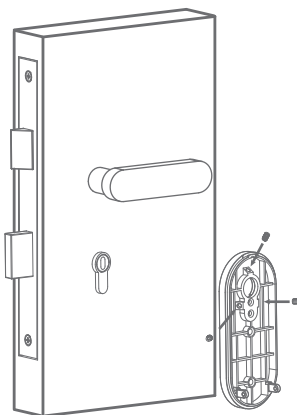

3. Insert the key

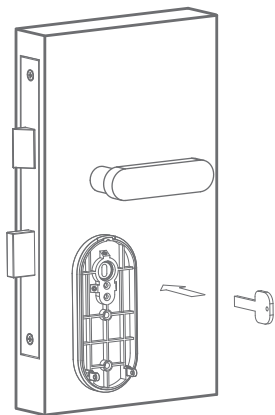

4. Turn the key to check if it can be turned smoothly and if the lock bolt is retractable

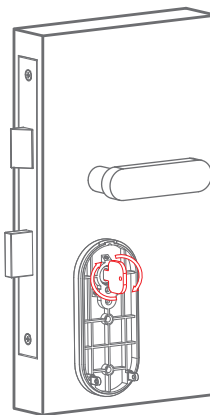

5. Install the main body of the lock; make sure the snap is snapped on the bottom plate and the key is inserted in the slot of the knob

6. Fix the main body with two screws; turn the knob to check if it can be turned smoothly and if the lock bolt is retractable

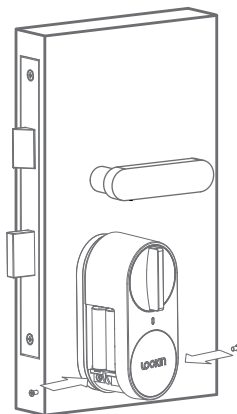
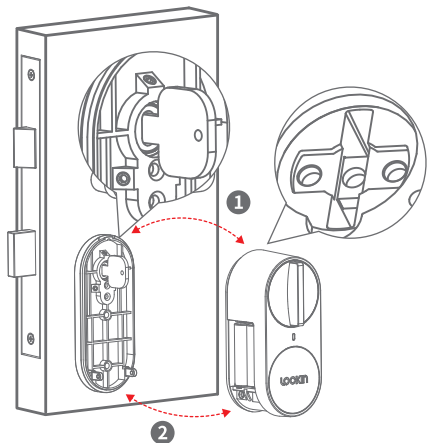

7. Close the battery cover

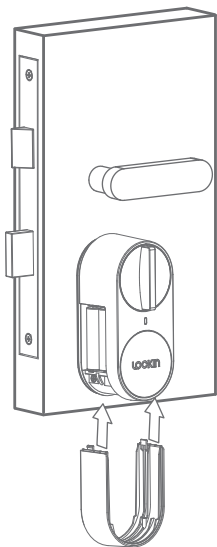

8. Installation of the lock's main part is completed. Please install the Door Sensor properly as per the following steps.

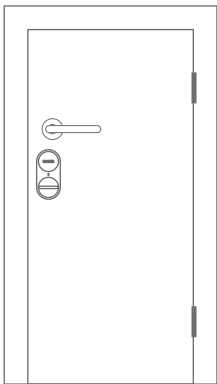

9. Install <Auxiliary Card for Installation> on G30 Smart Lock.

(Note: When the lock is on the right side of the door, please install <Auxiliary Card for Installation> in an inverted way.)

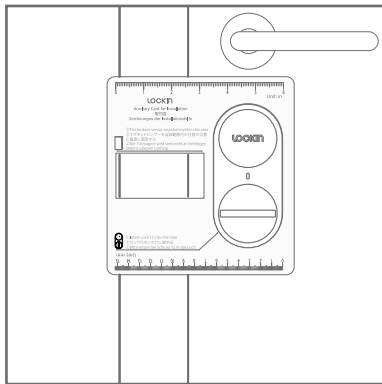

10. Based on the designated position of <Auxiliary Card for Installation>, fix the Door Sensor to door frame with double-sided tape.

(Note: The Door Sensor may not operate in case of the iron door and other doors where the magnetic force does not work well. In this case, please adopt timed Auto Lock without Door Sensor.)

11. Installation is completed.

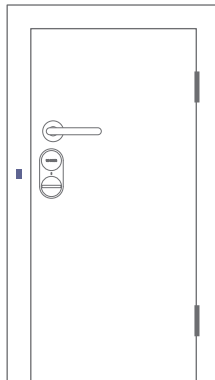
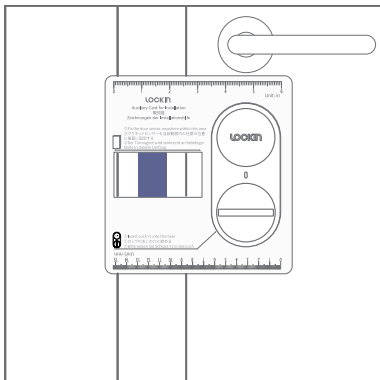

Contact us

www.lockin.com

support@lockin.com

Chongqing Luxiangjia Technology Co., Ltd.

No.50 Industrial Avenue, Pulu Street, Tongliang District, Chongqing