

Reolink Professional Series

RP-WCB8MZ

4K Wi-Fi 6 Camera with 5X Optical Zoom and Color Night Vision



4K

4K Resolution
@25fps



Dual-Band
Wi-Fi 6



5x Optical
Zoom



133° Ultra-Wide
Diagonal Field
of View



Color
Night Vision



AI Video
Search



Person & Object
Detection



Perimeter
Protection



Infrared
Night Vision



Smart Event
Detection



IP67 Weatherproof



Metal
Housing



Active
Deterrent



Alarm Input/Output
Interface



Two-Way
Audio



H.265/H.264 Dual
Codec Support

Reolink Feature Descriptions

AI Video Search

Find the footage you need faster with AI-powered video search. Simply enter a natural language description—such as “a woman wearing a yellow t-shirt” or “vehicles”—to quickly locate relevant recordings. In addition to text-based search, when used with Reolink’s Professional Series NVR, the system offers advanced search tools, quick-access shortcuts, and the ability to revisit previous search history, making video retrieval smarter and more efficient.

Smart Detection

The Smart Detection system accurately identifies a wide range of targets, including people, motor vehicles, animals, non-motorized vehicles, and packages. It can also recognize abnormal events such as Object Removal and Forgotten Object, enhancing situational awareness and security response.

Perimeter Protection

Reolink’s Perimeter Protection provides a powerful layer of security by monitoring defined areas with precision. It features Line Crossing Alerts to detect movement across virtual boundaries, Zone Intrusion Alerts for unauthorized entry into preset zones, and Zone Loitering Alerts to flag prolonged presence in sensitive areas. These smart functions enable proactive threat detection and faster response.

512GB microSD Card Storage

Supports up to 512GB microSD card, allowing for extended local storage of high-resolution footage without relying on external devices. This ample capacity allows for longer recording durations and easy playback access, providing reliable video retention for enhanced security.

AI-ISP

AI-ISP is an AI-powered image enhancement technology designed to improve video clarity and brightness, particularly in low-light environments. It intelligently adjusts image parameters to deliver sharper, more detailed footage in challenging lighting conditions.

Multiple Light Modes

Equipped with both infrared LEDs and spotlights, the camera offers flexible lighting options. It automatically switches to infrared mode at night for clear black-and-white images in low-light environments. When spotlight is enabled, it delivers full-color night vision. Choose from three spotlight modes—Always On, Alarm-Triggered, and Manually Off—to suit different security needs and provide effective visual deterrence.

Rugged & Weatherproof Design

Built for the outdoors, the camera features an IP67-rated enclosure for full protection against dust and water. It operates reliably in extreme temperatures from -30°C to +55°C (-22°F to 131°F), making it ideal for harsh environments. The sturdy metal housing enhances durability and impact resistance, ensuring long-term stability and dependable performance in all weather conditions.

Flexible Alarm Integration

The system includes one alarm input and one alarm output port, allowing seamless integration with external alarm devices such as sensors, speakers, and strobe lights. The ports support up to 12V/1A for input and 12V/500mA for output, enabling reliable and responsive alarm connectivity for enhanced security setups.

Reolink Specification

Video & Audio	
Image Sensor	1/2.8" CMOS Sensor
Resolution	3840x2160 (8 Megapixels) @25fps
Lens	f=2.7-13.5mm, Max.F=1.6
Zoom	5X
Video Compression	H.265/H.264
Field of View	Horizontal: 108.6°- 32°
	Vertical: 56.2°- 18°
	Diagonal: 133°- 36.7°
Day & Night	IR-cut filter with auto-switching
Infrared Night Vision	Up to 30 meters(100ft); LED: 4pcs/850nm
Color Night Vision	Spotlights: 4pcs LEDs/4000K/600 lumens
Frame Rate	Main Stream: 2fps - 25fps(default: 25fps)
	Sub Stream: 4fps - 15fps(default: 10fps)
Code Rate	Main Stream: 2048Kbps - 5120Kbps(default: 4096Kbps)
	Sub Stream: 64Kbps - 512Kbps(default: 256Kbps)
Audio	Two-way audio
AI	
AI Video Search	Yes
Person & Object Detection	Person, Motor Vehicle Detection, Non-motorized vehicle Detection, Animal Detection, Package Detection, Motion Detection
Smart Event Detection	Object Removal Detection(Beta) , Forgotten Object Detection(Beta)
Perimeter Protection	Line Crossing Alert, Zone Intrusion Alert, Zone Loitering Alert
Smart Detection Setting	Person object size; Person sensitivity; Person alarm delay; Motor Vehicle object size; Motor Vehicle sensitivity; Motor Vehicle alarm delay; Animal object size; Animal sensitivity; Animal alarm delay; Non-motorized vehicle object size; Non-motorized vehicle sensitivity; Non-motorized vehicle alarm delay; Package object size; Package sensitivity; Package alarm delay; Detection zone
Software	
Browser Supported	Edge, Chrome, Firefox, Safari
OS Supported	PC: Windows, Mac OS; Smartphone: iOS, Android
Protocols & Standards	HTTPS, SSL, TCP/IP, UDP, HTTP, IPv4, UPnP, RTSP, RTMP, SMTP, NTP, DHCP, DNS, DDNS, FTP, P2P, ONVIF
User Access	Max. 20 users (1 admin & 19 users);
	Max. 12 simultaneous streams (2 main & 10 sub streams)
Other Features	
Record Mode	Motion-triggered recording (default); Scheduled recording, 24/7 recording
Smart Home Compatibility	Google Assistant
AI ISP	Yes
WDR	Yes
Time Lapse	Yes
Power	
DC Power	DC 12.0V= 2A, <15W
Wi-Fi	
Wireless Standard	IEEE 802.11 ac/ax/a/b/g/n
Operating Frequency	2.4GHz/5GHz
Wireless Security	WPA/WPA2/WPA3
Interface	
Reset Button	Yes
Ethernet	One 10M/100Mbps RJ45
Storage	microSD card slot (Max. 512GB), Reolink NVR, FTP
Audio In/Out	Built-in Microphone & Speaker
Alarm In/out	1 Input, 1 Output (Input: 12V/1A; Output: 12V/500mA)
Working Environment	
Operating Temperature	-30°C~+55°C
Operating Humidity	10% ~ 90%
Weatherproof	IP67
Mechanical	
Dimensions	76x74x220mm
Weight (Without Accessories)	776g
Warranty	
Limited Warranty	3-year limited warranty. For support, visit https://support.reolink.com/hc/en-us/ .

- ① Daylight Sensor
- ② Spotlight
- ③ Lens
- ④ Infrared Lights
- ⑤ microSD Card Slot
- ⑥ Mount
- ⑦ Speaker
- ⑧ PoE Port
- ⑨ Reset Button
- ⑩ Power Port(optional)
- ⑪ Alarm In/Out

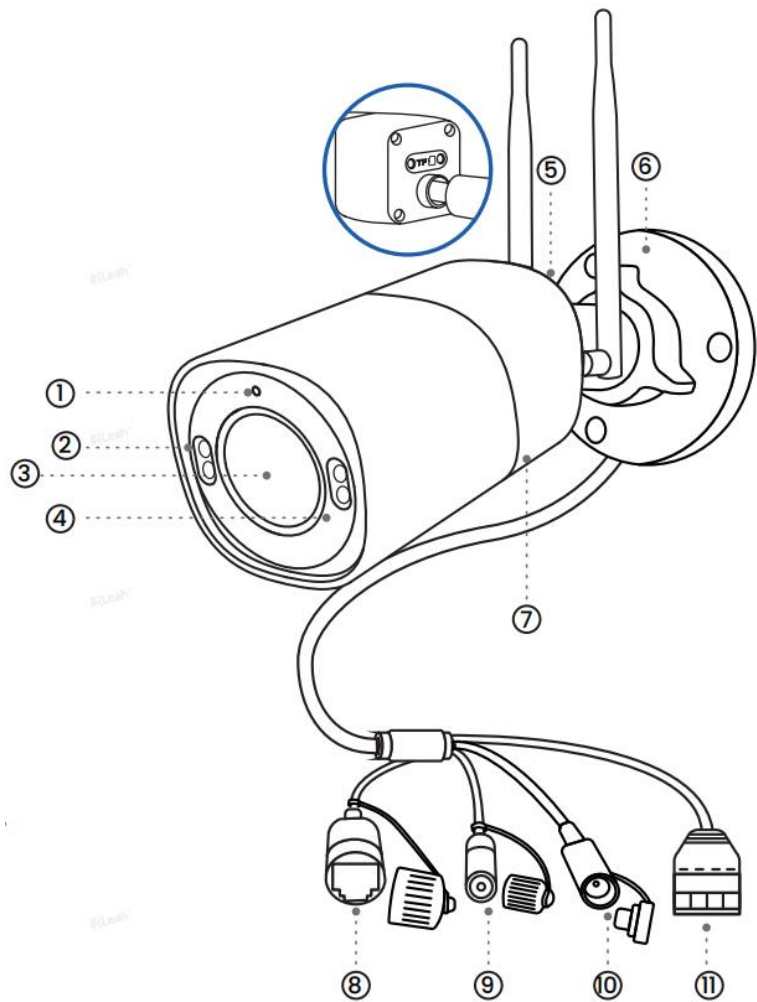

Wall Mount

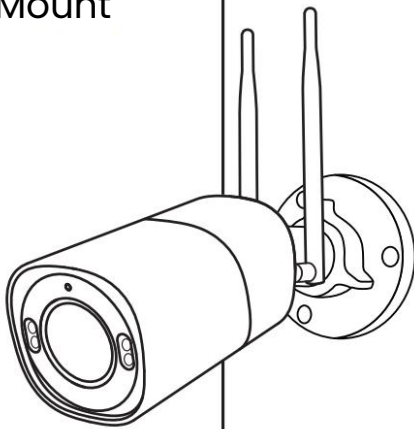

Ceiling Mount

